

# KIENE

Patent pending

Leaflet K-1360

DIESEL ACCESSORIES, INC.

## K-1360 Clutch Brake Cutter

*Quickly removes one-piece clutch brakes  
for mechanical clutches . . .*

### COMPLETELY REMOVE A CLUTCH BRAKE IN 15 TO 20 MINUTES!

Removing a clutch brake is a difficult, messy, hazardous job. Torch cutting is the usual solution, but it's slow and dangerous. The **K-1360 Clutch Brake Cutter** makes the job safer and much easier!

- **No more torching!** Drill through and then finish with an air chisel.
- **No need to pull transmission.**
- **The safe and cost effective way to remove a one-piece clutch brake.**

*The Clutch Brake Cutter Kit includes . . .*

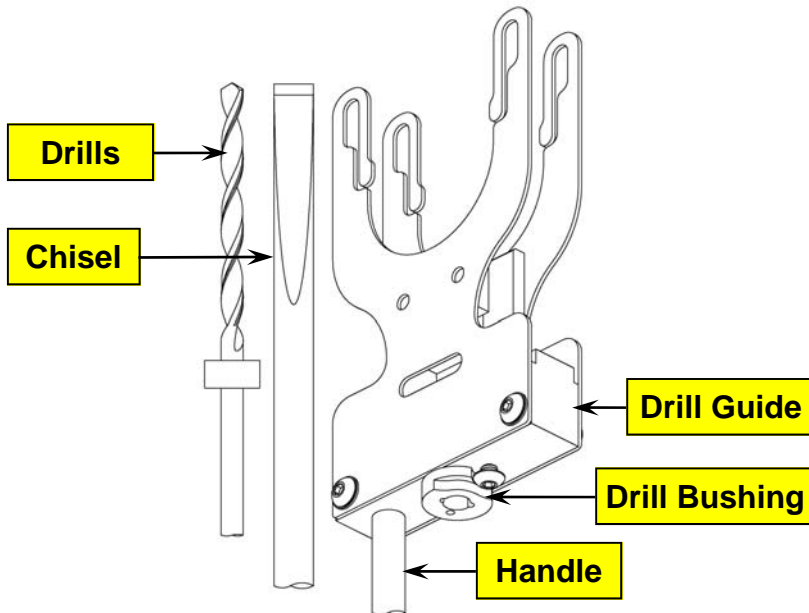

#### **How it works . . .**

1. Position the K-1360 and clamp in place with clutch pedal.
2. Drill through clutch brake.
3. Finish cut with the air chisel.
4. Rotate clutch brake and repeat process.

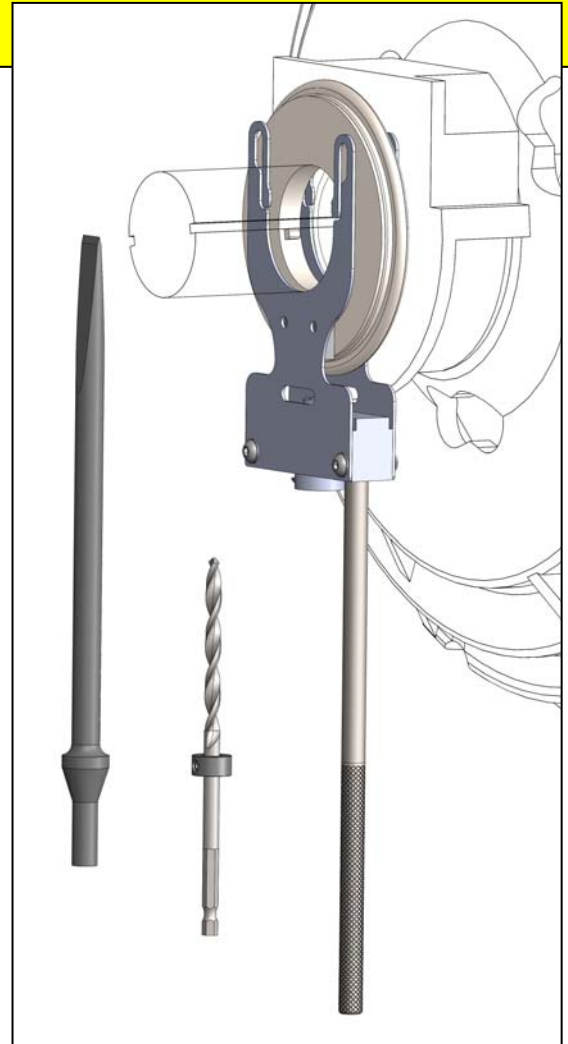

**MADE IN THE U.S.A.**

**KIENE Equipment ...**  
*an investment in safety  
and productivity*

**KIENE**  
DIESEL ACCESSORIES, INC.

325 S. Fairbank Street, Addison, Il., 60101  
Phone: 1-800-264-5950 • 630-543-5950 • Fax: 630-543-5953  
www.kienediesel.com • e-mail: info@kienediesel.com