

E4-WM5-Y633A00

MOUNTING INSTRUCTION



IMPORTANT! READ THIS FIRST!

Installation of shock absorbers requires special tools and expert knowledge. Accordingly, installation of all BILSTEIN products must be performed by a qualified suspension specialist.

When replacing other brands, BILSTEIN shock absorbers should always be installed as a set. All BILSTEIN products must only be used for the specific, intended application as indicated in the application guide. **Any use of any BILSTEIN product other than for its intended use may result in serious bodily injury or death.**

Always use a chassis hoist for the installation of BILSTEIN products and make certain that the raised vehicle is securely attached to the hoist and/or supported to prevent the vehicle from slipping, falling, or moving during the installation process.

If you choose to install any BILSTEIN product without the necessary special tools, expertise or chassis hoist, you may subject yourself to the risk of serious bodily injury or death. If you elect not to use a chassis hoist, at least make sure the vehicle is on level ground, that all tires on the ground during installation are blocked to prevent movement, that at least two tires are on the ground at all times, and that adequately secured safety stands (jack stands) are used to support the chassis. **NEVER** get under the vehicle until you have checked to make sure all of these steps are performed.

BILSTEIN suspension products are gas-filled and are highly pressurized.

- Never place any BILSTEIN product in a vise or use a clamp on any BILSTEIN product.
- Never apply heat near any BILSTEIN product.
- Never attempt to open or repair any BILSTEIN product, in order to prevent **serious bodily injury or death.**

Any attempt to misuse, misapply, modify, or tamper with any BILSTEIN suspension product voids any warranty and **may result in serious bodily injury or death.**

While installing any BILSTEIN product:

- Do not use impact tools for loosening or tightening fasteners, because this may destroy the screw threads.
- Self-locking fasteners must only be used **once!**
- Reuse original equipment components only if they are in good condition, otherwise replace them with new components.
- Never remove the slight film of oil on the piston rod and seal.
- All mounting fasteners for shocks and struts must be securely tightened before the vehicle is operated.

After installing any BILSTEIN product:

- The suspension caster and camber must be checked and/or adjusted to comply with the vehicle manufacturer's specifications.
- The (load dependent) brake compensator and the anti-lock brake system must be checked and/or reset to comply with the vehicle manufacturer's specifications.
- The headlight aim must be checked and adjusted.

Be sure to properly dispose of all old parts.

E4-WM5-Y633A00

MOUNTING INSTRUCTION



BILSTEIN B8 5160 Shock Absorbers are designed to fit your vehicle's original shock mounts with no modifications. The B8 5160 shocks are installed in the same manner as a standard replacement shock.

Shock Installation Procedure:

- A. Remove the existing shocks from the vehicle following all procedures in the vehicle manufacturer's service manual.
- B. The left and right rear shocks are different and need to be installed as follows:
 - 25-299946 – LEFT REAR
 - 25-299267 – RIGHT REAR

For steps C to I, refer to Figure 1 for the proper installation order and orientation of the stem mounting hardware

- C. Attach the lower mount, but do not torque the bolt yet.
- D. Using the supplied stem mounting hardware, install one of the Bilstein washer (concave side up), sleeve, and lower bushing on the shock stem.
- E. Install the Bilstein Shock Absorber in the original location so the **BILSTEIN lettering on the bracket is facing outwards**.

Note: On both sides of the vehicle the reservoir will be positioned forwards of the main shock tube [see Figures 2 and 3].

- F. Install the upper bushing, Bilstein washer (concave side down), and lock nut onto the shock stem. If a chassis hoist has been used, be sure to lower the vehicle such that its full weight is on the suspension prior to fully tightening the fasteners.
- G. Tighten the lower mount fasteners to the vehicle manufacturer's service manual torque specification.
- H. Tighten the lock nut on the stem until it bottoms out and torque to 45 N·m (34 lb·ft).
- I. Carefully check for any possible interference between the reservoirs and any other components on the vehicle. If any interference is found, go back to Step E and verify the reservoirs are in the correct positions. The reservoir positions depicted herein are appropriate for most vehicles for which these shocks are intended, however, some wheel/tire and/or lift kit combinations may create interference problems. It is the responsibility of the installer to determine if the reservoirs are positioned appropriately and if there is any potential for interference.
- J. If no potential interference is found the installation is complete.

E4-WM5-Y633A00 MOUNTING INSTRUCTION

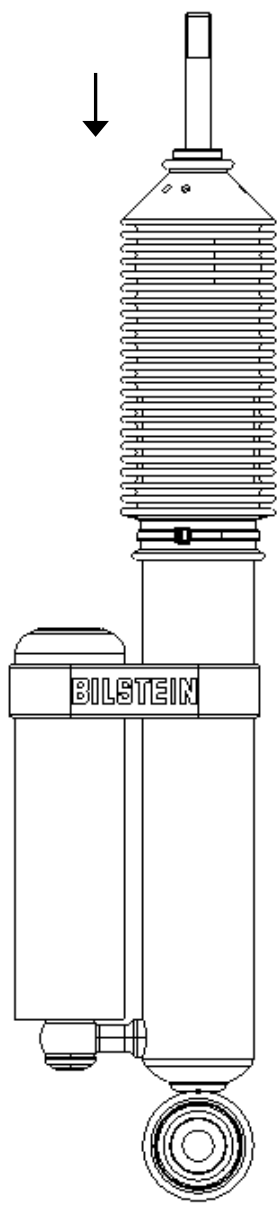
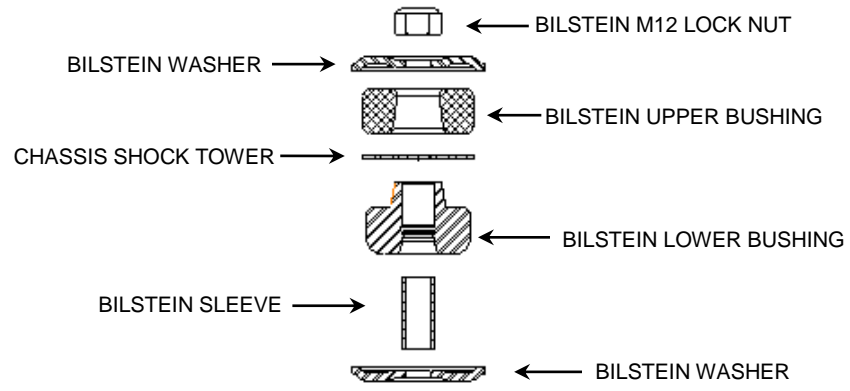

Figure 1
(Left rear depicted)

E4-WM5-Y633A00 MOUNTING INSTRUCTION



Figure 2 – LEFT REAR



Figure 3 – RIGHT REAR

Note: The shocks differ slightly in appearance from the supplied components.