

E4-WM5-Y662A00

MOUNTING INSTRUCTION



IMPORTANT! READ THIS FIRST!

Installation of shock absorbers requires special tools and expert knowledge. Accordingly, installation of all BILSTEIN products must be performed by a qualified suspension specialist.

When replacing other brands, BILSTEIN shock absorbers should always be installed as a set. All BILSTEIN products must only be used for the specific, intended application as indicated in the application guide. **Any use of any BILSTEIN product other than for its intended use may result in serious bodily injury or death.**

Always use a chassis hoist for the installation of BILSTEIN products and make certain that the raised vehicle is securely attached to the hoist and/or supported to prevent the vehicle from slipping, falling, or moving during the installation process.

If you choose to install any BILSTEIN product without the necessary special tools, expertise or chassis hoist, you may subject yourself to the risk of serious bodily injury or death. If you elect not to use a chassis hoist, at least make sure the vehicle is on level ground, that all tires on the ground during installation are blocked to prevent movement, that at least two tires are on the ground at all times, and that adequately secured safety stands (jack stands) are used to support the chassis. **NEVER** get under the vehicle until you have checked to make sure all of these steps are performed.

BILSTEIN suspension products are gas-filled and are highly pressurized.

- Never place any BILSTEIN product in a vise or use a clamp on any BILSTEIN product.
- Never apply heat near any BILSTEIN product.
- Never attempt to open or repair any BILSTEIN product, in order to prevent **serious bodily injury or death.**

Any attempt to misuse, misapply, modify, or tamper with any BILSTEIN suspension product voids any warranty and **may result in serious bodily injury or death.**

While installing any BILSTEIN product:

- Do not use impact tools for loosening or tightening fasteners, because this may destroy the screw threads.
- Self-locking fasteners must only be used **once!**
- Reuse original equipment components only if they are in good condition, otherwise replace them with new components.
- Never remove the slight film of oil on the piston rod and seal.
- All mounting fasteners for shocks and struts must be securely tightened before operating the vehicle.

After installing any BILSTEIN product:

- The suspension caster and camber must be checked and/or adjusted to comply with the vehicle manufacturer's specifications.
- The (load dependent) brake compensator and the anti-lock brake system must be checked and/or reset to comply with the vehicle manufacturer's specifications.
- The headlight aim must be checked and adjusted.

E4-WM5-Y662A00 MOUNTING INSTRUCTION



Installation Procedure:

- A. Remove the existing rear shocks from the vehicle following all procedures in the vehicle manufacturer's service manual.
- B. An optional spring seat spacer is included that will yield a 1" (25mm) lift. The spring seat spacer is depicted in Figure 2. If stock ride height would like to be retained, skip to step H. If a 1" (25mm) lift is what is desired, continue on to step C.
- C. Note the orientation of the coil spring and the upper spring seat clocking relative to the vehicle. It is recommended to mark the coil spring, top spring seat, and mounting post as shown in **Figure 1** to indicate the clocking (important for reassembly). Then, remove the coil spring following all procedures in the vehicle manufacturer's service manual.

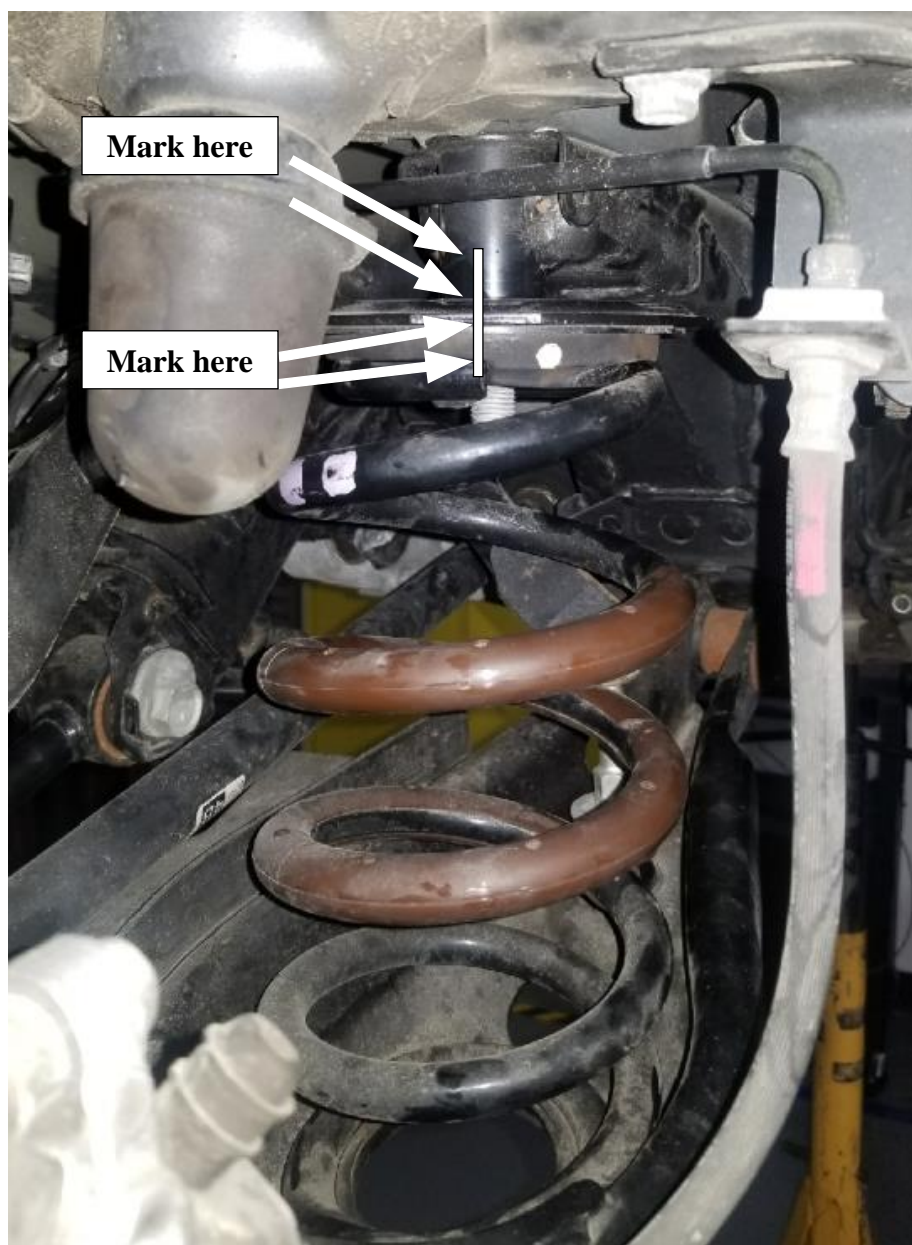

Figure 1

E4-WM5-Y662A00 MOUNTING INSTRUCTION



Item	Description	Qty.
1	Spring Seat Spacer	1

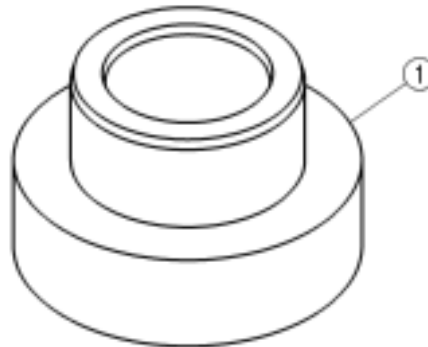

Figure 2

D. Remove the spring seat by unbolting it from the vehicle as shown in **Figure 3**.

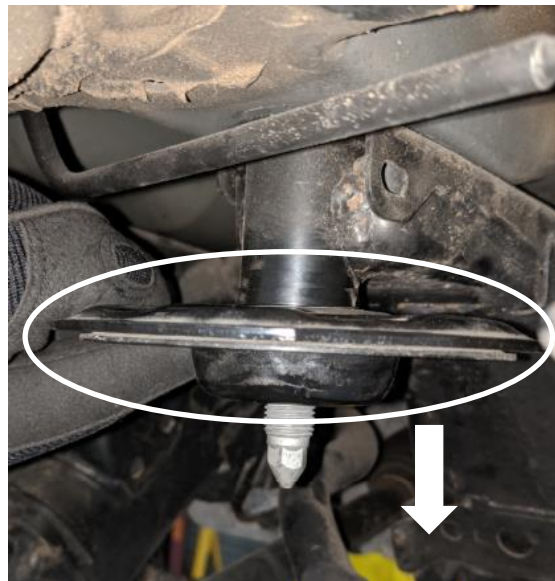

Figure 3

E4-WM5-Y662A00 MOUNTING INSTRUCTION



- E. Place the spring seat spacer with the larger diameter into the spring seat as shown in **Figures 4 and 5**.



Figure 4



Figure 5

- F. Install the spring seat back onto the vehicle with the factory nut as shown in **Figures 6 and 7**. Torque down to manufacturer's specifications. Repeat steps C-F for the other side.



Figure 6



Figure 7

- G. Install the factory springs back onto the vehicle. Clock the spring and spring seat back to original location as shown in step C (**Figure 1**).
- H. Install the Bilstein shocks onto the vehicle and tighten all fasteners to vehicle manufacturer's specifications.
- I. If a chassis hoist has been used, be sure to lower the vehicle such that its full weight is on the suspension prior to fully tightening the fasteners.
- J. Check wheel alignment and if necessary, adjust to the vehicle manufacturer's specification. This completes the installation.